

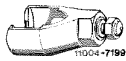
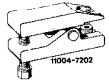

33-400 R and R steering knuckle

Tightening torques		Nm
Hex. nut of guide joint		40
Hex. nut of supporting joint		80
Self-locking hex. head fitted screw for fastening		115
– fixed caliper to steering knuckle		90
– floating caliper to steering knuckle		90
Hex. screws of steering knuckle arm		80
Special tools		
Remover for supporting joint		116 589 09 33 00
Remover for guide joint of steering knuckle		116 589 16 33 00
Puller and remover for wheel cap		116 589 22 33 00
Holder for dial gauge for adjusting wheel bearing end play		363 589 02 21 00
Conventional tool		
Dial gauge A 1 DIN 878	e.g. made by Mahr, D-7300 Esslingen order no. 810	
Self-made tool		
Spacing plate	refer to illustration item 13	

Notes

Loosen hex. nuts on supporting and guide joint with the front spring installed only when the supporting jacks are resting against lower control arms instead of frame floor; if not, remove front spring.

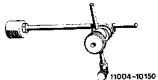
Do not press off guide joint with front axle halves free of load, since this will damage rubber sleeve.

During assembly jobs, immediately replace damaged sleeves of supporting or guide joint (33-430).

33-400 R and R steering knuckle

Do not replace damaged or leaking sleeve on joints which have already been used. In such a case, always replace supporting joint or upper control arm.

Be sure to replace self-locking nuts and bolts!

Removal

1 Jack up vehicle at the front, place supporting jacks outside against lower control arms. Remove front wheel.

2 Unscrew steering knuckle arm (29) from steering knuckle.

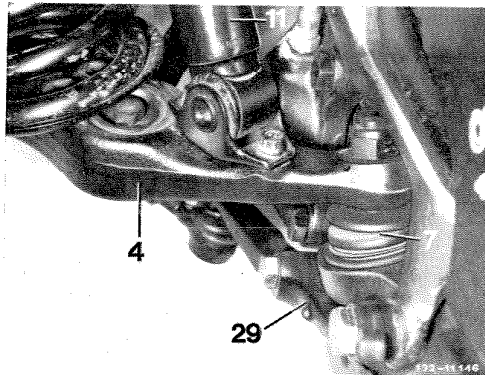

3 Unscrew brake caliper from steering knuckle and attach to torsion bar by means of a suitable hook. Do not expose brake hose to tensile stress.

Note: On vehicles with ABS, additionally remove rpm sensor from steering knuckle (42-712).

4 Remove front wheel hub (33-310).

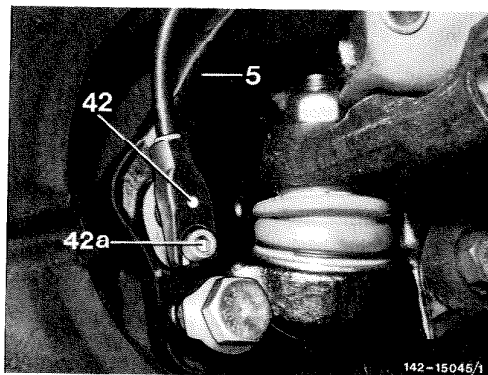

5 Loosen hex. nut on guide joint (8) and remove joint from steering knuckle by means of tool.

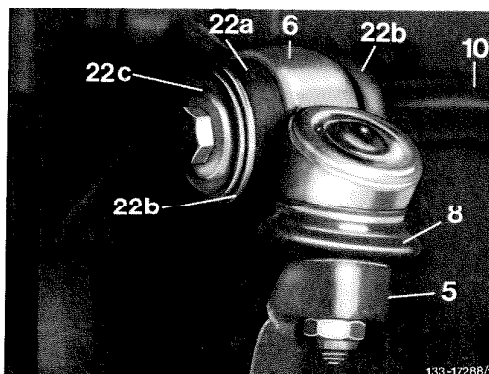

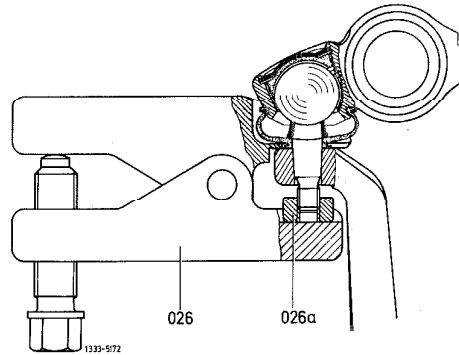

026 Remover
026a Thrust piece

6 Loosen hex. nut on supporting joint (arrow).

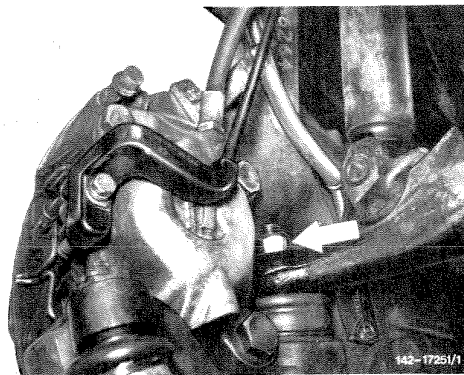

7 Swing steering knuckle (5) at top slightly outward and force supporting joint from lower control arm (4) by means of tool (02).

8 Remove steering knuckle.

9 If required, unscrew cover plate from steering knuckle.

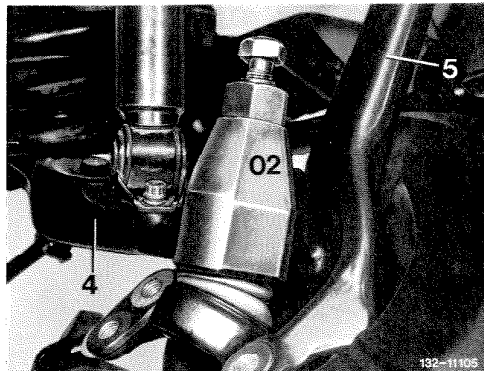

Installation

10 Check supporting joint in steering knuckle (33-425).

11 Check cover plate and screw to steering knuckle.

33-400 R and R steering knuckle

12 Attach steering knuckle to lower and upper control arm.

Attention!

Keep cone of ball pins and seats in steering knuckle or lower control arm free of grease. Use new self-locking hex. nuts.

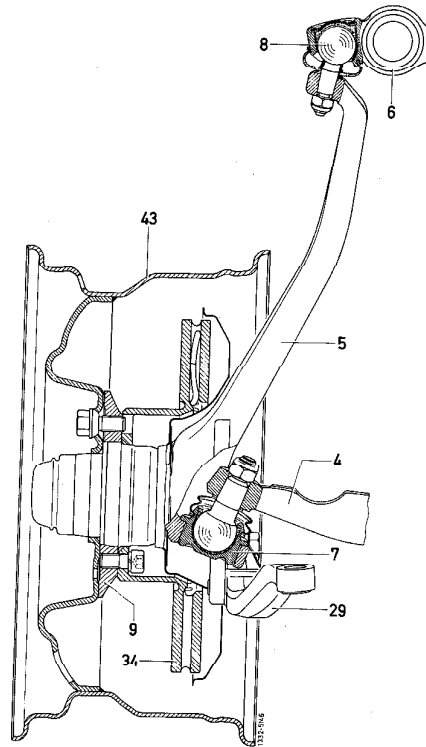

- 4 Lower control arm
- 5 Steering knuckle
- 6 Upper control arm
- 7 Supporting joint
- 8 Guide joint

13 If the ball pin on guide or supporting joint is turning when the hex. nut is tightened insert spacing disc (037) and pull cone of ball pin into steering knuckle (5) or lower control arm (4) by tightening hex. nut. Then loosen hex. nut, remove spacing plate and tighten hex. nut to specified torque. The spacing plate can be self-made.

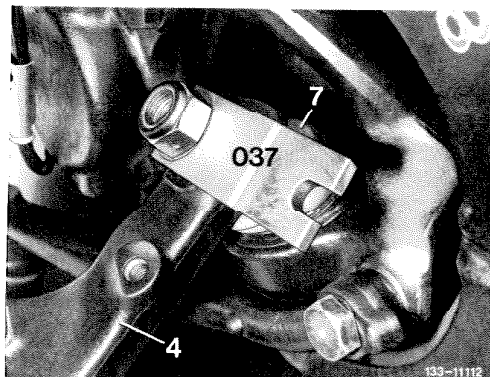
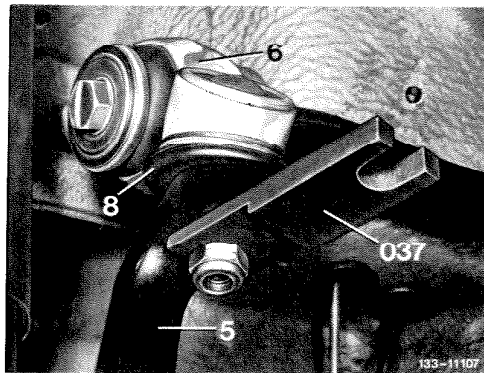

33-400 R and R steering knuckle

Spacing plate can be self-made.

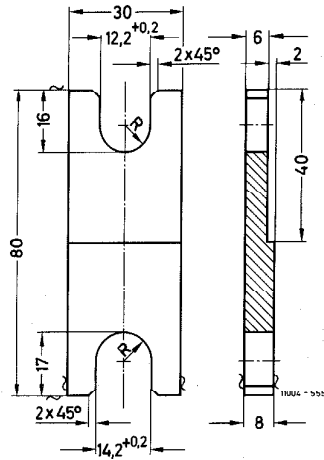

14 Install front wheel hub (33-310).

15 On vehicles with ABS, fasten rpm sensor in steering knuckle by means of hex. socket screw.

16 Adjust wheel bearing end play (33-300).

17 Install brake caliper (42-100).

Attention!

Do not twist brake hose and do not subject to tensile stresses.

18 Mount steering knuckle arm to steering knuckle with new self-locking bolts.

19 Mount front wheel, lower vehicle.

20 Check wheel adjustment at front axle (40-320).

21 Check adjustment of head lights.